

# KD-7000

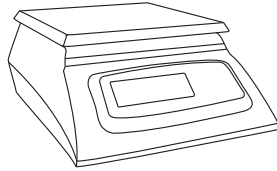

ENGLISH



Capacity  
7000g x1g  
15.4lb x 0.1oz

Thank you for purchasing the My Weigh® KD-7000 digital scale. Please read all operating instructions carefully before use. This electronic scale is a precision instrument. With normal care and proper treatment, it will provide years of reliable service. For more information please visit [www.myweigh.com](http://www.myweigh.com).

Never load the scale with more than the maximum capacity. Although the KD-7000 is designed to be extremely durable with extra overload protection built into the case, overloading will permanently damage it! Avoid any exposure to extreme heat or cold, your scale works better when operated at normal room temperature. Keep your scale in a clean environment. Dust, dirt, moisture, vibration, air currents and/or a close proximity to other electronic equipment can all cause an adverse effect on the reliability and accuracy of your scale. Handle with care. Gently apply all items to be weighed onto the tray top. Avoid shaking, dropping or otherwise shocking the scale. Scales are delicate instruments and unlike cellular phones, scales have delicate sensors that determine how much an item weighs. If you drop or shock your scale, these sensors “feel” the shock and are sometimes destroyed. This happens with all digital scales. We design our scales to be as resistant to shock or drops as possible, however there is no way for us to protect 100% against load cell or sensor damage. Failure to follow these instructions will void your warranty.

Always allow the scale to acclimate to normal room temperature for at least one hour before use. Give your scale sufficient warm up time. Usually 30-60 seconds before calibration to give the internal components a chance to stabilize.

## POWER SUPPLY

### AC Adapter

The scale can be powered by an AC adaptor- output is DC 5V 300mA. Please only use the correct adapter for this scale – an incorrect adapter can cause damage to the scale and possible fire or injury. Use of an incorrect adapter will also void your warranty.

### Batteries

Low Batteries & bad battery connections are the #1 cause of scale malfunction and inaccuracy! We test all of our scale returns from consumers and 60% of them are battery related problems. This sounds silly but it's true! A scale will perform poorly when it has low batteries. Use good quality batteries & replace them often (Remove the batteries if you plan to store the scale for longer than 14 days). We include good quality batteries with all of our scales but they can run low in storage. If your scale simply won't turn on while on battery power, it is often caused by loose battery connections.

### Battery installation

- Press and lift open the battery cover located at the bottom of the unit.
- Insert 3 x AA batteries and make sure the polarity is correct.
- Close the battery cover until it clicks shut.

Note : If the battery symbol appears in the display, it means low battery power. It is time to replace the batteries.

## OPERATION INSTRUCTIONS

---

### Weighing Procedures

1. Press [⏻] to turn on the scale.

When the power is turned on, the scale will countdown for a few seconds and "0" will appear on the display.

2. Select the weighing unit with [MODE]. Press [MODE] to select a weighing unit g, kg, oz, lb, lb:oz. Once the unit has been selected, the selected unit will be displayed next to the weight value.

3. Start weighing. Verify the reading is "0". Place objects on the weighing platform to weigh. When the reading becomes stable, the stable indicator is displayed.

### Tare

Tare can be used for eliminating the weight value of an empty container. Place an empty container on the scale and press [TARE]. Then place the items to be weighed in the container. NOTE: When all weight is removed from the weighing tray, the tared value of a container will be displayed as a negative number. Press [TARE] again to return the scale to zero.

### CALIBRATION

---

Calibration may be required when the scale is first set up for use, or if the scale is moved to a different altitude or new location. This is necessary because the weight of a mass in one location is not necessarily the same in another location. Also, with time and use, mechanical deviations can occur.

**How to calibrate: \*\*You must have an accurate 5kg weight or combination of weights in order to calibrate.\*\***

1. The scale must be powered OFF. Press and hold [MODE] and [⏻], release both keys and wait for the display to show "CALE".

2. Place a 5kg weight(s) on the platform. Wait a few seconds then press [TARE]. Calibration is complete when the display reads "PASS", now you can remove the weight(s).

4. Turn the scale OFF then turn it back ON and check some weight readings. If calibration is still incorrect, repeat calibration.

### WEIGHT RESPONSE SPEED & AUTO OFF SETTINGS

---

1. Press and hold [HOLD] and the [⏻] key to power on the scale for 3 seconds and then release. Press [MODE] to scroll from "nb0" to "nb2" (nb0 is slowest - nb2 is fastest), press [TARE] for confirmation.

2. The display will show "OFF 0" (disabled) or "OFF 1" (automatic turn off after about 2 minutes) or "OFF 2" (automatic turn off after about 5 minutes), select the auto turn off time by pressing [MODE], confirm by pressing [TARE]. The scale will return to the normal weighing mode.

### FEATURES

---

#### Power Up Segment Test

When first turning the unit on, the scale will run a quick diagnostic and it will display a countdown. This display will remain for a few seconds and then reset to zero.

#### Overload indicator

When the display shows "-----", this indicates an overload. Remove excessive load immediately. Remember: you can permanently damage the scale and void your warranty by overloading it!

## Negative Value

Any tared value will be displayed as a negative number once all weight is removed, press **[TARE]** to re-zero the scale.

## Auto off

An auto shut off feature is provided to conserve battery power.

## Hold

Press the **[HOLD]** to hold the current weight reading, press **[HOLD]** again to cancel.

## Back light

On the back of the scale next to the AC socket is the back light switch. Slide it to enable or disable the backlight.

## Beep Feature

To enable or disable the Beep Feature slide the other switch at the back of the scale.

## Removable Protective LCD Cover

When using the KD-7000 be sure the clear protective LCD cover is not touching the underside of the tray as this may cause inaccurate readings. **To remove the cover simply lift up all the way and slide to the right.**

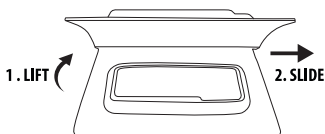
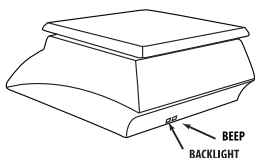

## SPECIFICATIONS

Capacity	7000g x 1g	Units	kg, g, lb:oz, lb, oz
Auto-OFF	Adjustable auto-off time		
Scale dimension	9.8" x 8" x 3.8" (250mm x 205mm x 100mm)		
Tray dimension	7" x 7" (175mm x 175mm)		
Scale weight	22 oz / 600 g		
Operating temperature	Optimum 10-40°C (50-104°F)		
Power Source	3 x AA Batteries / Adapter - DC 5V 300mA		
Tare range	Up to scale's maximum capacity		

## DISPLAY SYMBOLS

-0-	Scale is in ZERO mode
	Battery is low
	Current reading is stable

